

Qty. Description

1 CRN 3-11 A-FGJ-A-E-HQQE



Note! Product picture may differ from actual product

Product No.: [96517922](#)

Vertical, multistage centrifugal pump with inlet and outlet ports on same the level (inline). Pump materials in contact with the liquid are in high-grade stainless steel. A cartridge shaft seal ensures high reliability, safe handling, and easy access and service. Power transmission is via a rigid split coupling. Pipe connection is via combined DIN-ANSI-JIS flanges.

The pump is fitted with a 3-phase, fan-cooled asynchronous motor.

Liquid:

Pumped liquid: Water
Liquid temperature range: -20 .. 120 °C
Selected liquid temperature: 20 °C
Density: 998.2 kg/m³

Technical:

Pump speed on which pump data are based: 3501 rpm
Rated flow: 3.5 m³/h
Rated head: 79.2 m
Pump orientation: Vertical
Shaft seal arrangement: Single
Code for shaft seal: HQQE
Approvals: CE,EAC,UKCA,SEPRO
Approvals for drinking water: WRAS,ACS
Curve tolerance: ISO9906:2012 3B

Materials:

Base: Stainless steel
EN 1.4408
AISI 316
Impeller: Stainless steel
EN 1.4401
AISI 316
Bearing: SIC

Installation:

Maximum ambient temperature: 60 °C
Maximum operating pressure: 25 bar
Max pressure at stated temp: 25 bar / 120 °C
25 bar / -20 °C
Type of connection: DIN / ANSI / JIS
Size of inlet connection: DN 25/32
Size of outlet connection: DN 25/32
Pressure rating for connection: PN 25
Flange rating inlet: 300 lb
Flange size for motor: FT115



Company name:

Created by:

Phone:

Date:

28/10/2024

Qty.	Description
------	-------------

1	Electrical data:
	Motor standard: IEC
	Motor type: 90SD
	Rated power - P2: 1.5 kW
	Power (P2) required by pump: 1.5 kW
	Mains frequency: 60 Hz
	Rated voltage: 3 x 230-277D/400-480Y V
	Rated current: 5,30-5,00/3,05-2,90 A
	Starting current: 780-980 %
	Cos phi - power factor: 0.85-0.75
	Rated speed: 3480-3530 rpm
	IE Efficiency class: NEMA Premium / IE3 60Hz
	Motor efficiency at full load: 85.5 %
	Motor efficiency at 3/4 load: 87.5-86.3 %
	Motor efficiency at 1/2 load: 87.1-83.7 %
	Number of poles: 2
	Enclosure class (IEC 34-5): 55 Dust/Jetting
	Insulation class (IEC 85): F
	Motor No: 85U01906
	Controls:
	Frequency converter: None
	Others:
	Terminal box position: 6
	Minimum efficiency index, MEI ≥: 0.70
	Net weight: 34.8 kg
	Gross weight: 38.9 kg
	Shipping volume: 0.092 m³
	Country of origin: TW
	Custom tariff no.: 8413700000

96517922 CRN 3-11 A-FGJ-A-E-HQQE 60 Hz

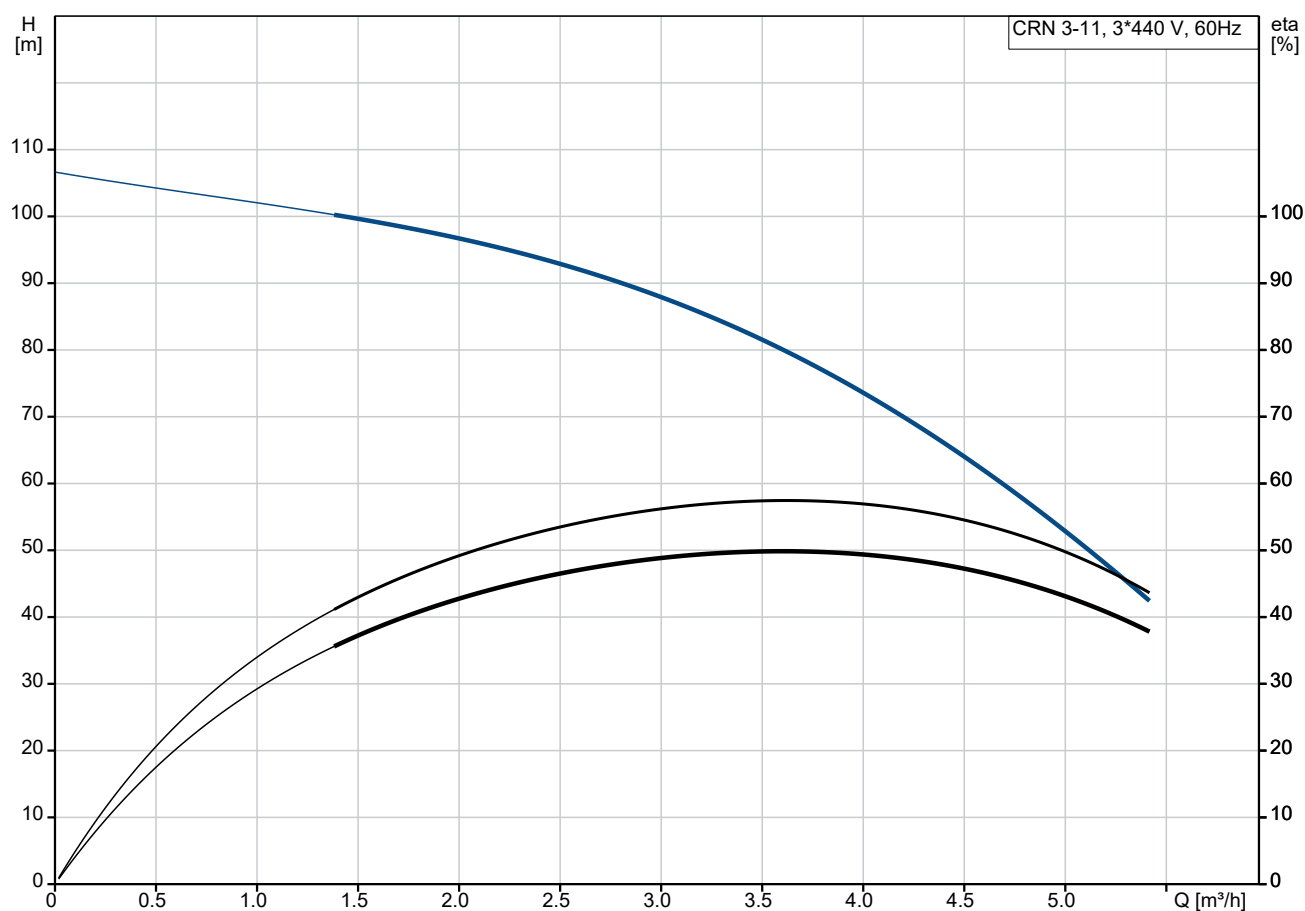

Pumped liquid = Water
 Liquid temperature during operation = 20 °C
 Density = 998.2 kg/m³

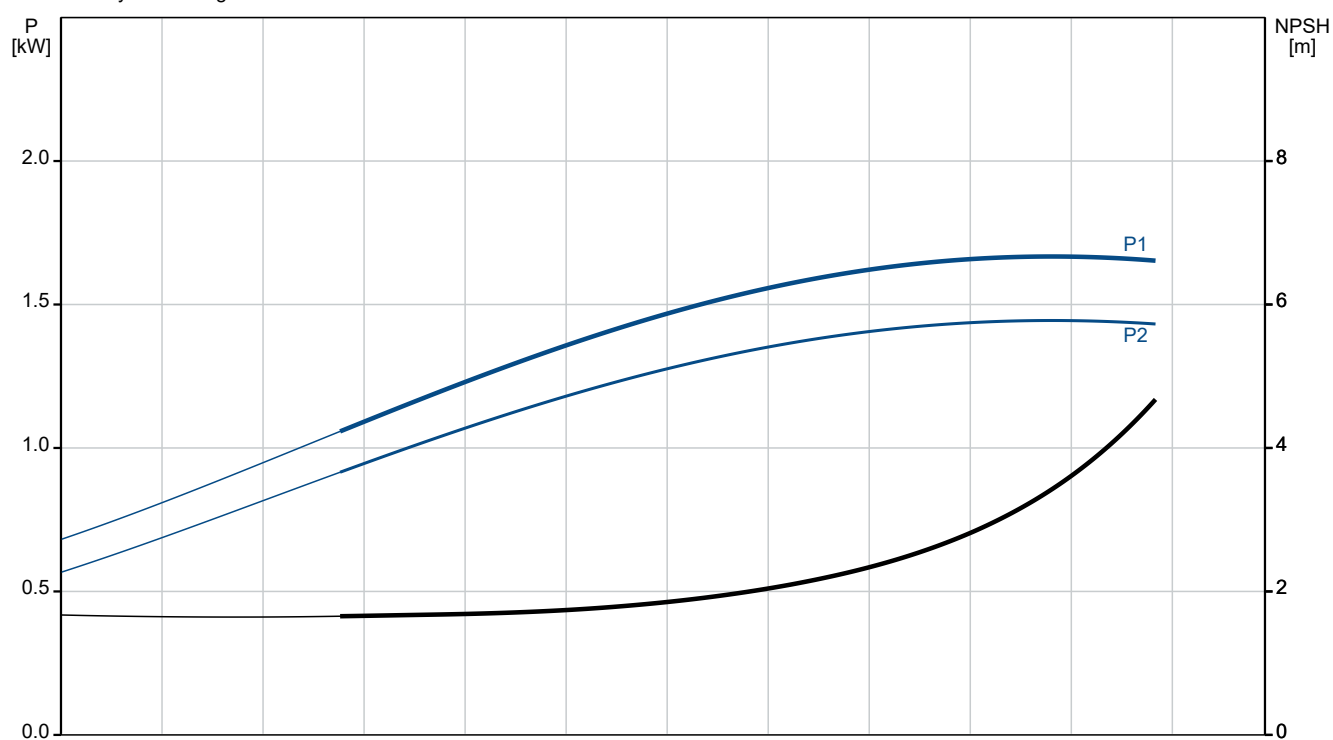

Description	Value
General information:	
Product name:	CRN 3-11 A-FGJ-A-E-HQQE
Product No:	96517922
EAN number:	5700396772646
Technical:	
Pump speed on which pump data are based:	3501 rpm
Rated flow:	3.5 m³/h
Rated head:	79.2 m
Maximum head:	105.3 m
Stages:	11
Impellers:	11
Number of reduced-diameter impellers:	0
Low NPSH:	N
Pump orientation:	Vertical
Shaft seal arrangement:	Single
Code for shaft seal:	HQQE
Approvals:	CE,EAC,UKCA,SEPRO
Approvals for drinking water:	WRAS,ACS
Curve tolerance:	ISO9906:2012 3B
Pump version:	A
Model:	A
Materials:	
Base:	Stainless steel
Base:	EN 1.4408
Base:	AISI 316
Impeller:	Stainless steel
Impeller:	EN 1.4401
Impeller:	AISI 316
Material code:	A
Code for rubber:	E
Bearing:	SIC
Installation:	
Maximum ambient temperature:	60 °C
Maximum operating pressure:	25 bar
Max pressure at stated temp:	25 bar / 120 °C
Max pressure at stated temp:	25 bar / -20 °C
Type of connection:	DIN / ANSI / JIS
Size of inlet connection:	DN 25/32
Size of outlet connection:	DN 25/32
Pressure rating for connection:	PN 25
Flange rating inlet:	300 lb
Flange size for motor:	FT115
Connect code:	FGJ
Liquid:	
Pumped liquid:	Water
Liquid temperature range:	-20 .. 120 °C
Selected liquid temperature:	20 °C
Density:	998.2 kg/m³
Electrical data:	
Motor standard:	IEC
Motor type:	90SD
Rated power - P2:	1.5 kW
Power (P2) required by pump:	1.5 kW
Mains frequency:	60 Hz
Rated voltage:	3 x 230-277D/400-480Y V
Rated current:	5,30-5,00/3,05-2,90 A

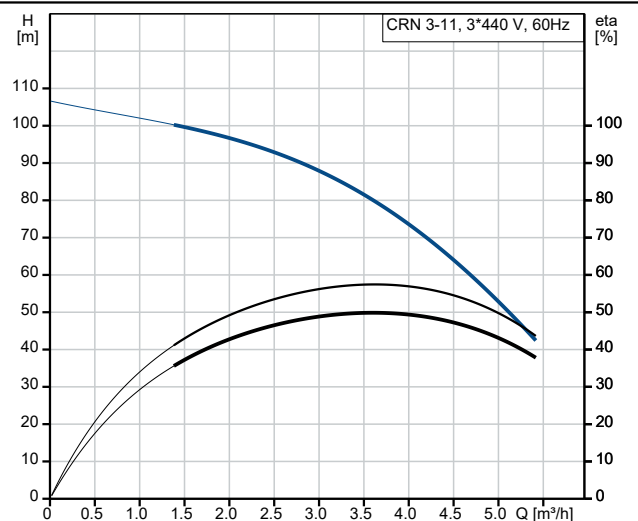

Pumped liquid = Water
Liquid temperature during operation = 20 °C
Density = 998.2 kg/m³

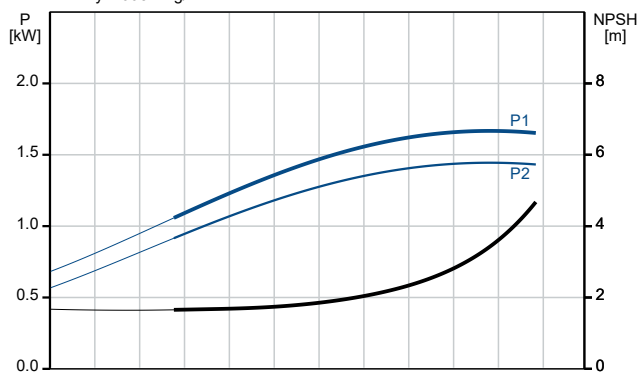



Company name:

Created by:

Phone:

Date:

28/10/2024

Description	Value
Starting current:	780-980 %
Cos phi - power factor:	0.85-0.75
Rated speed:	3480-3530 rpm
IE Efficiency class:	NEMA Premium / IE3 60Hz
Motor efficiency at full load:	85.5 %
Motor efficiency at 3/4 load:	87.5-86.3 %
Motor efficiency at 1/2 load:	87.1-83.7 %
Number of poles:	2
Enclosure class (IEC 34-5):	55 Dust/Jetting
Insulation class (IEC 85):	F
Built-in motor protection:	NONE
Motor No:	85U01906
Controls:	
Frequency converter:	None
Others:	
Terminal box position:	6
Minimum efficiency index, MEI ≥:	0.70
Net weight:	34.8 kg
Gross weight:	38.9 kg
Shipping volume:	0.092 m ³
Country of origin:	TW
Custom tariff no.:	8413700000

96517922 CRN 3-11 A-FGJ-A-E-HQQE 60 Hz

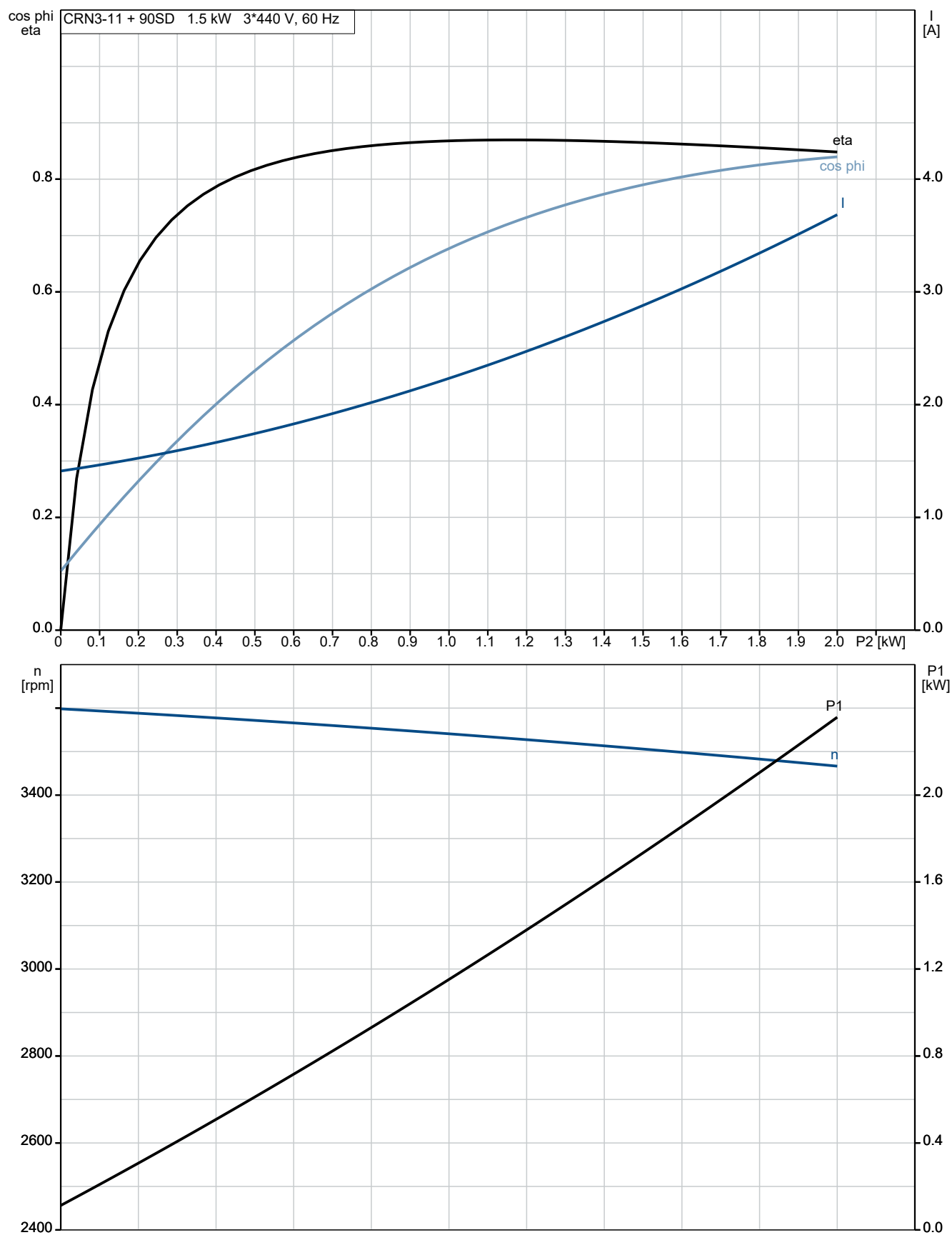

96517922 CRN 3-11 A-FGJ-A-E-HQQE 60 Hz

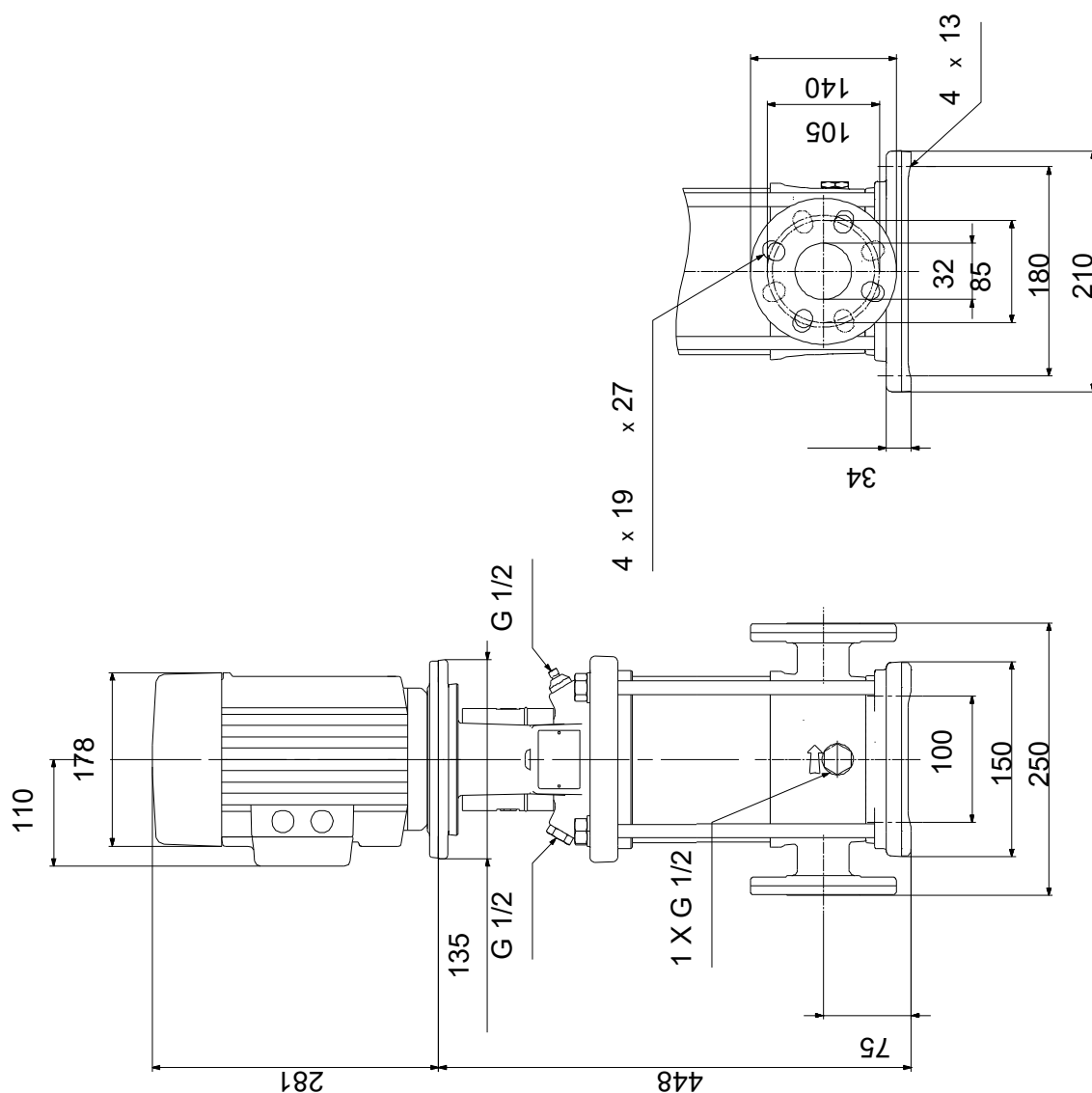

Note! All units are in [mm] unless others are stated.
Disclaimer: This simplified dimensional drawing does not show all details.

96517922 CRN 3-11 A-FGJ-A-E-HQQE 60 Hz

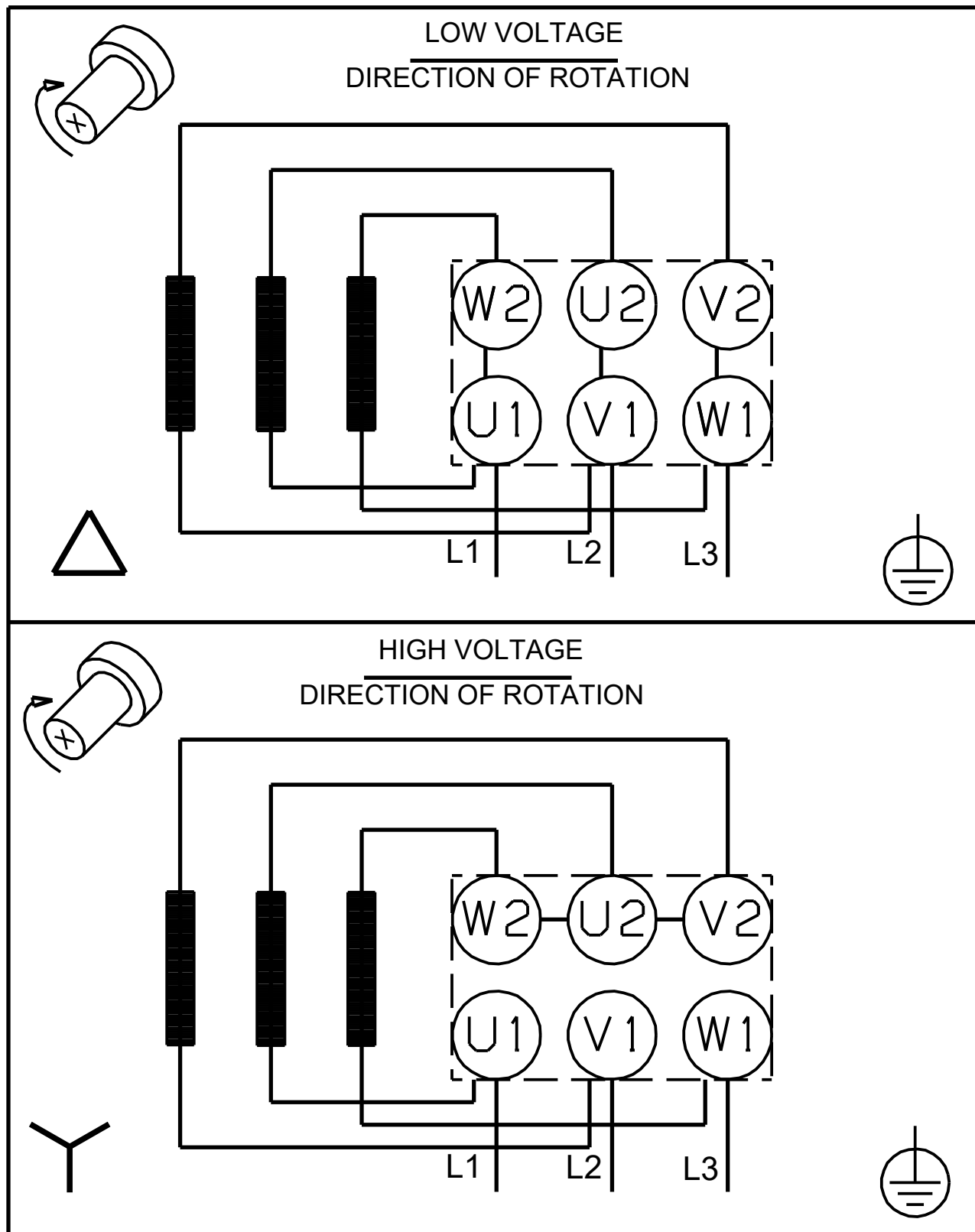

Note! All units are in [mm] unless others are stated.